

Derwent & Nidd

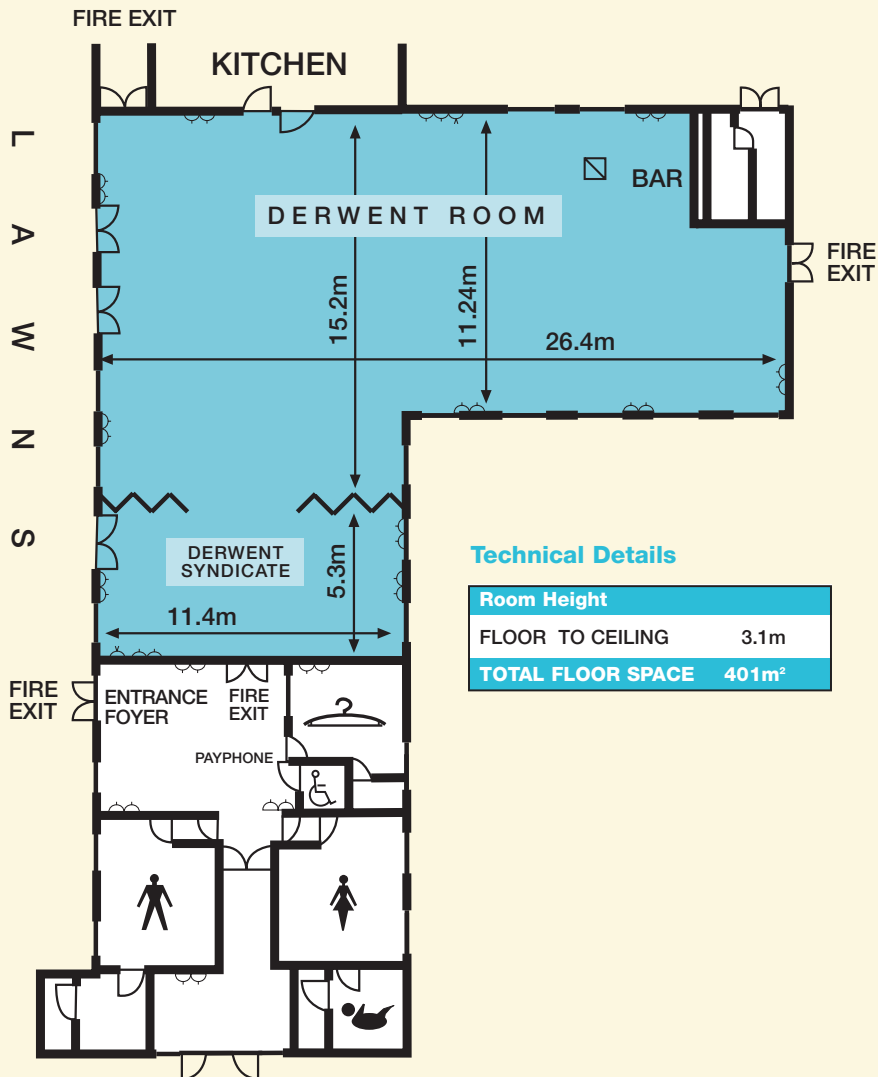

Designed for maximum flexibility of use, you can create breakout areas for conferences, or lounge and reception areas for social events with this highly versatile space. The adjoining **Calder Room** is perfect for a drinks reception, wedding ceremony, conference registration, dining or exhibition area when using the **Derwent Room**.



Technical Details

Room Height	
FLOOR TO CEILING	3.1m
TOTAL FLOOR SPACE	401m²

Derwent Room Capacities

LAYOUT STYLE	NUMBER
THEATRE	300
COCKTAIL RECEPTION	600
LUNCH/DINNER	240
DINNER & DANCE	180
CLASSROOM	80
BOARDROOM	70
U-SHAPE	60
CABARET	120

Derwent Syndicate Capacities

LAYOUT STYLE	NUMBER
THEATRE	50
COCKTAIL RECEPTION	80
CLASSROOM	16
BOARDROOM	20
U-SHAPE	20
CABARET	32

Legend

- CLOAKROOM
- LADIES' TOILET
- GENTS' TOILET
- DISABLED TOILET
- BABY CHANGE
- POWER SOCKET
- TV AERIAL POINT
- OVERHEAD POWER SUPPLY

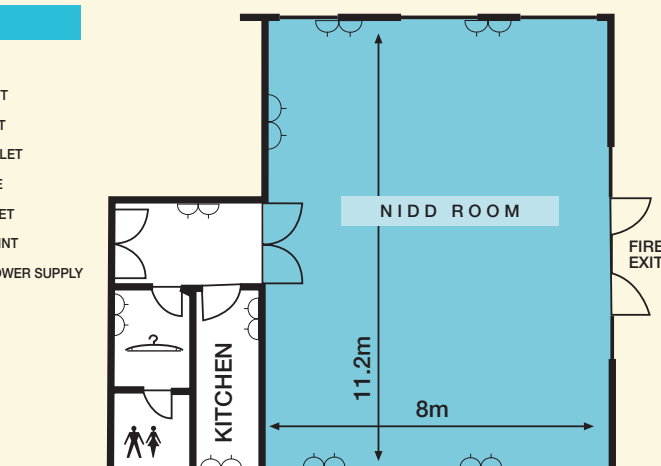

Nidd Room Capacities

LAYOUT STYLE	NUMBER
THEATRE	80
COCKTAIL RECEPTION	100
LUNCH/DINNER	60
DINNER & DANCE	40
CLASSROOM	30
BOARDROOM	34
U-SHAPE	24
CABARET	40

Technical Details

Room Height	
FLOOR TO CEILING	3.1m
TOTAL FLOOR SPACE	89m²